

## End Launch Connectors

### FPELC-KF-5

2.92mm, DC~40GHz

**Features:**

- Low VSWR
- No welding
- Reusable
- Easy installation

**Applications:**

- Laboratory Test

#### Electrical

Frequency	DC-40GHz
VSWR	1.35 max.
Impedance	50Ω

#### Mechanical

RF Connector	2.92mm female
Outer Conductor	Gold plated brass
Dielectric	PTFE
Inner Conductor	Gold plated beryllium copper

#### Environmental

Temperature	-40 ~ +105°C
-------------	--------------

#### Outline Drawings

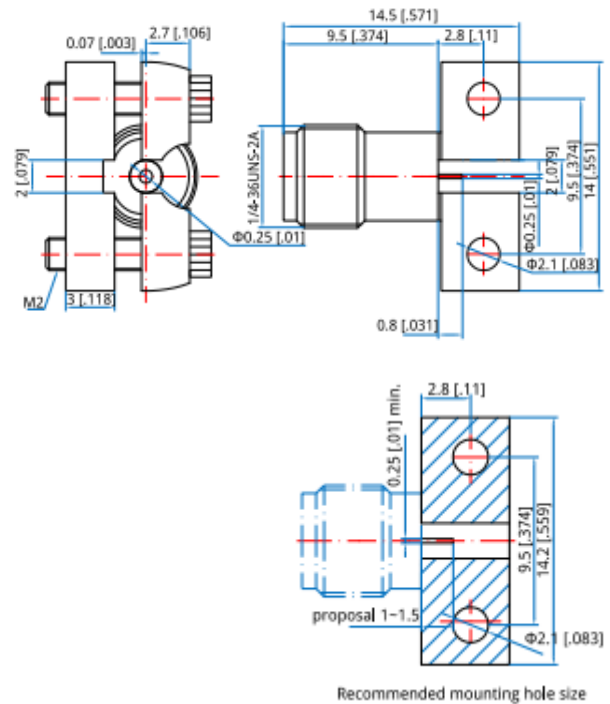

Unit: mm [in]

Tolerance: ±0.2mm [±0.008in](Screw sleeve)